

DEPARTMENT OF TRANSPORTATION STATE OF GEORGIA

PLAN AND PROFILE OF PROPOSED SR 316/US 29 @ SR 11 INTERCHANGE

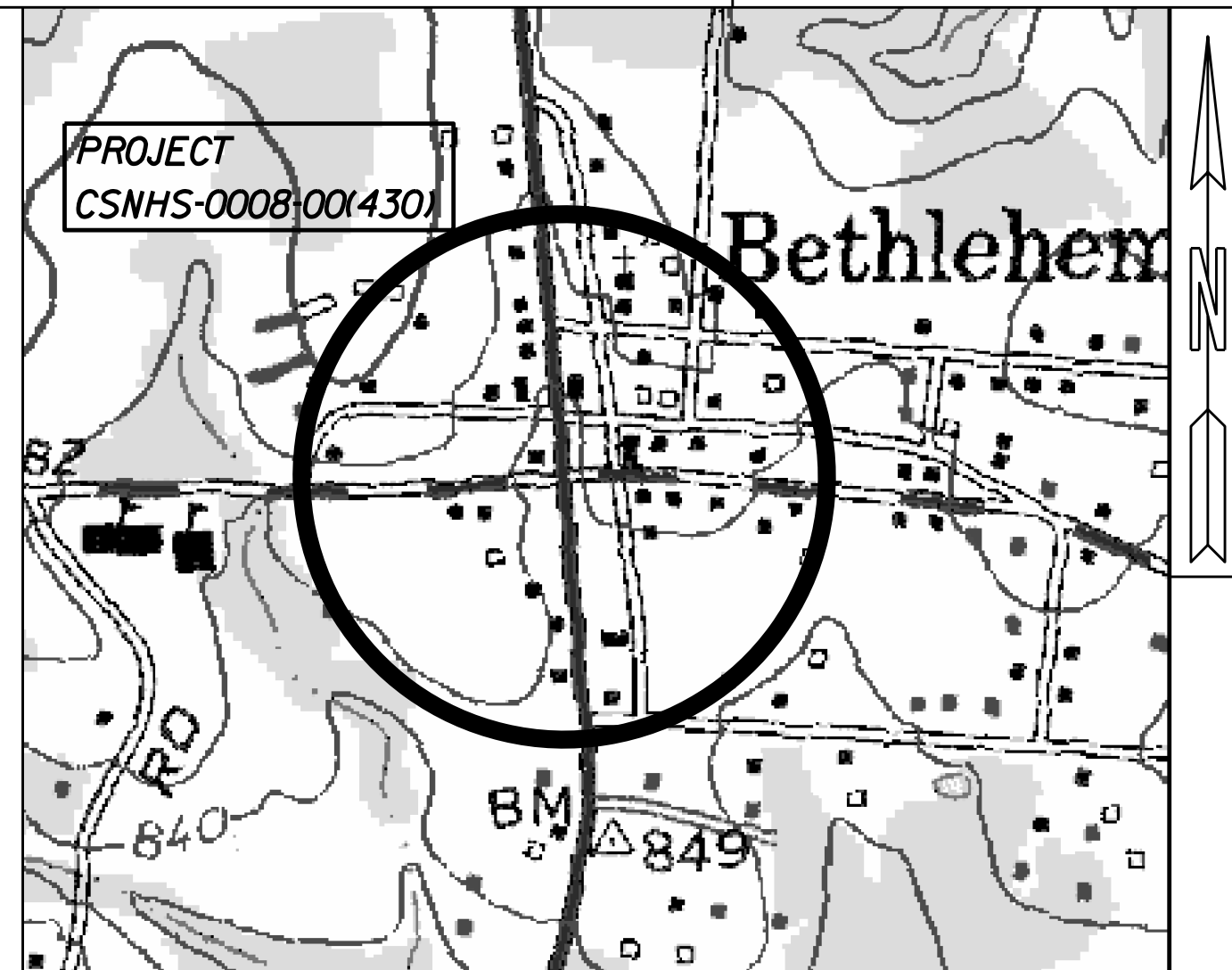
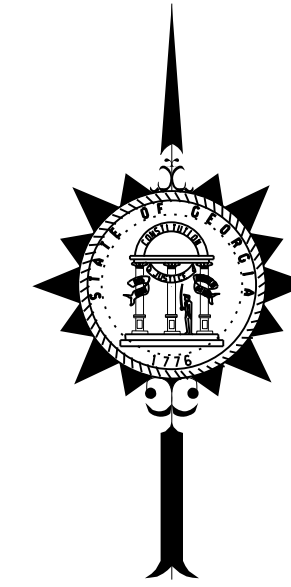

LOCATION SKETCH

DESIGN DATA: SR 316 SR 11
 TRAFFIC A.D.T.: 30,000 (2020) 14,500
 TRAFFIC A.D.T.: 44,600 (2040) 21,450
 TRAFFIC D.H.V.: 1,490 (ONE WAY) 815
 DIRECTIONAL DIST: 52/48 57/43
 % TRUCKS: 7.0% 7.5%
 24 HR. TRUCKS %: 9.0% 10.0%
 SPEED DESIGN: SR 316 65 MPH
 SR 11 55 MPH
 RAMPS 45 MPH
 ACCESS RDS 25 MPH

LOCATION & DESIGN APPROVAL DATE:
 FUNCTIONAL CLASS:
 SR 316 - RURAL PRINCIPAL ARTERIAL
 SR 11 - RURAL MINOR ARTERIAL

THIS PROJECT IS 100% IN BARROW COUNTY AND IS 100% IN CONG. DIST. NO. 10.

PROJECT DESIGNATION:
 DESIGNED IN ENGLISH UNITS.

THIS PROJECT HAS BEEN PREPARED USING THE HORIZONTAL GEORGIA COORDINATE SYSTEM OF 1984 (NAD 1983/94 WEST ZONE, AND THE NORTH AMERICAN VERTICAL DATUM (NAVD) OF 1988.

THE DATA TOGETHER WITH ALL OTHER INFORMATION SHOWN ON THESE PLANS OR IN ANYWAY INDICATED THEREBY, WHETHER BY DRAWINGS OR NOTES, OR IN ANY OTHER MANNER, ARE BASED UPON FIELD INVESTIGATIONS AND ARE BELIEVED TO BE INDICATIVE OF ACTUAL CONDITIONS. HOWEVER, THE SAME ARE SHOWN AS INFORMATION ONLY, ARE NOT GUARANTEED, AND DO NOT BIND THE DEPARTMENT OF TRANSPORTATION IN ANY WAY. THE ATTENTION OF BIDDER IS SPECIFICALLY DIRECTED TO SUBSECTIONS 102.04, 102.05, AND 104.03 OF THE SPECIFICATIONS.

FEDERAL AID PROJECT
 CSNHS-0008-00(430)

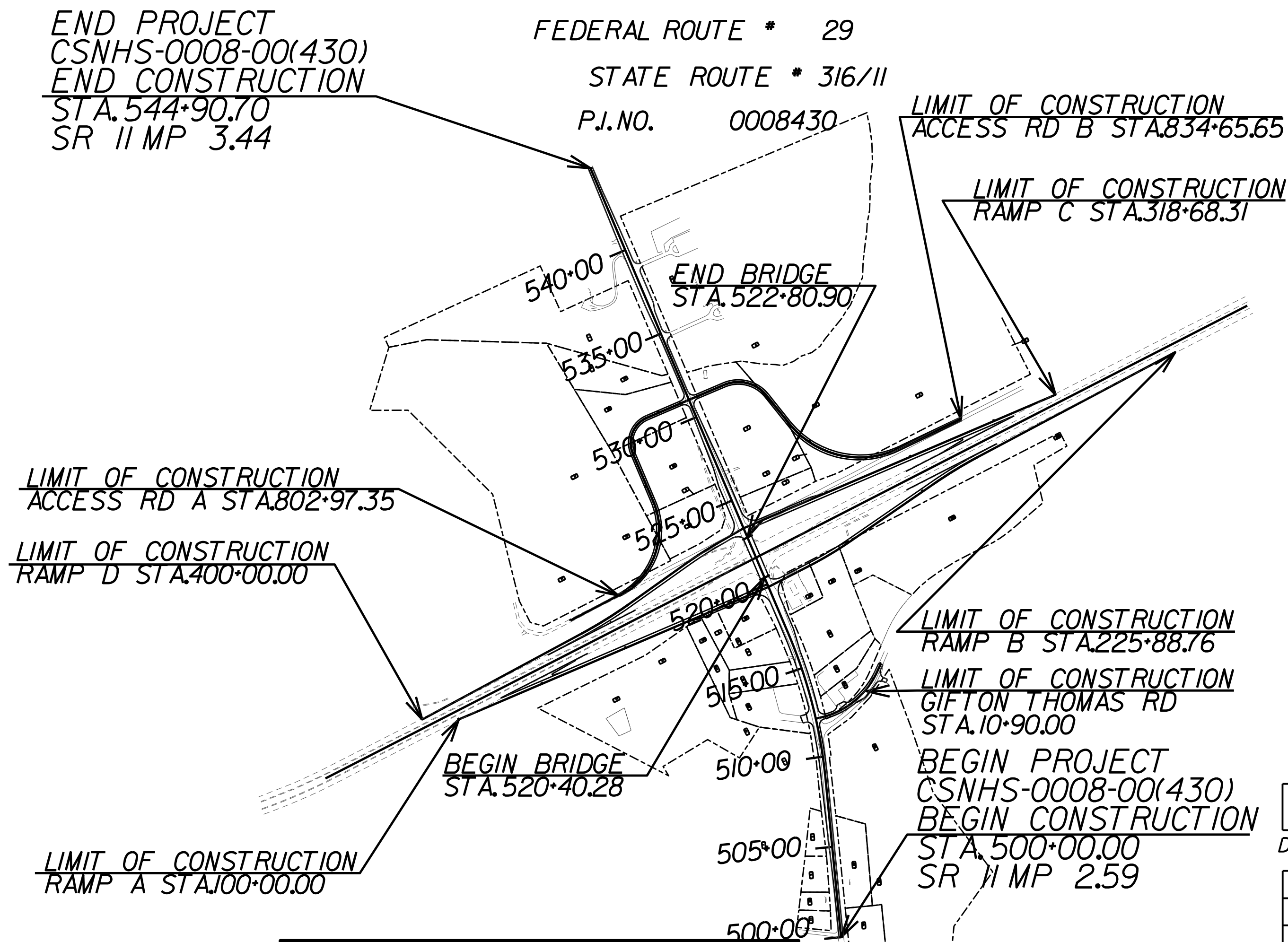

PREPARED BY: _____
 DESIGN ENGINEER

RECOMMENDED FOR SUBMISSION BY: _____
 DESIGN GROUP MANAGER

SUBMITTED BY: _____
 STATE ROADWAY DESIGN ENGINEER

DATE _____
 CHIEF ENGINEER

PLANS COMPLETED	- -
REVISIONS	

LENGTH OF PROJECT	
	COUNTY No. 3 BARROW Project No. CSNHS-0008-00(430)
	MILES
NET LENGTH OF ROADWAY	0.806
NET LENGTH OF BRIDGES	0.045
NET LENGTH OF PROJECT	0.851
NET LENGTH OF EXCEPTIONS	0.000
GROSS LENGTH OF PROJECT	0.851

