

STATE	PROJECT NUMBER	SHEET NO.	TOTAL SHEETS
GA.			

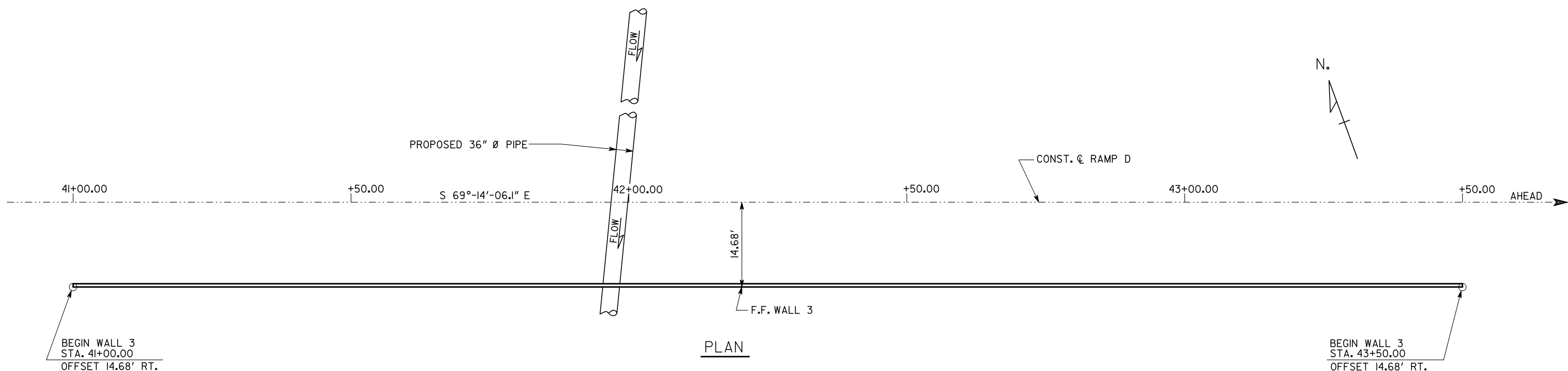

PLAN

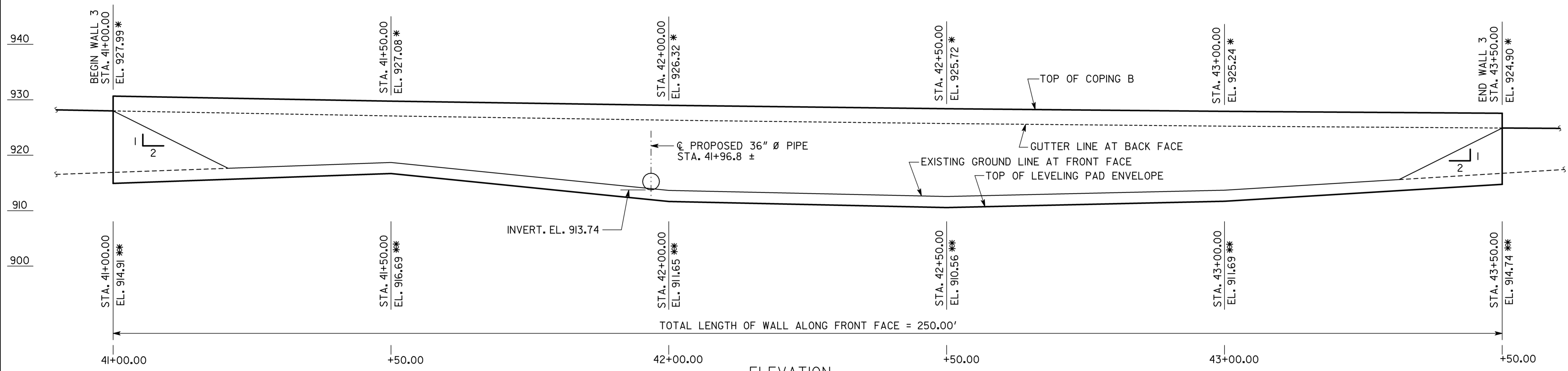

ELEVATION
(LOOKING AT FRONT FACE)

* - ELEVATIONS SHOWN ARE AT THE GUTTERLINE AT THE INSIDE FACE OF BARRIER. TOP OF COPING B ELEVATIONS ARE 2.67' ABOVE ELEVATION SHOWN.
 ** - ELEVATIONS SHOWN ARE MAXIMUM ELEVATIONS AT THE TOP OF LEVELING PAD.
 SEE GA. STD. 3054 FOR GUARDRAIL ATTACHMENT DETAILS AT ENDS OF WALL.
 ALL STATIONS SHOWN ARE ALONG CONST. ϕ RAMP D.

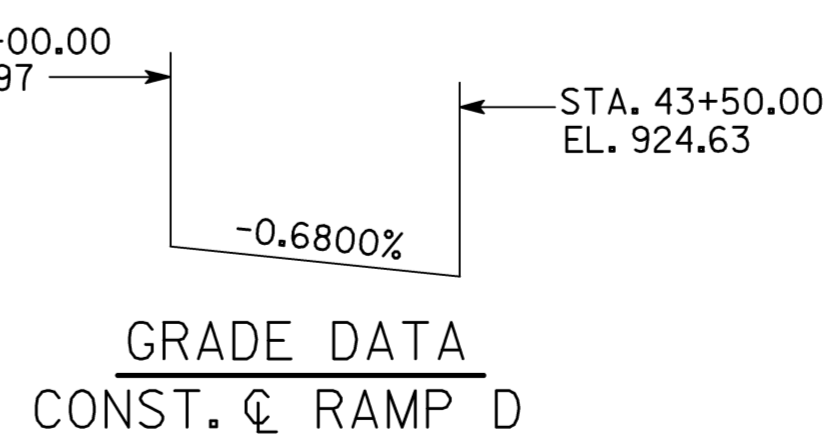
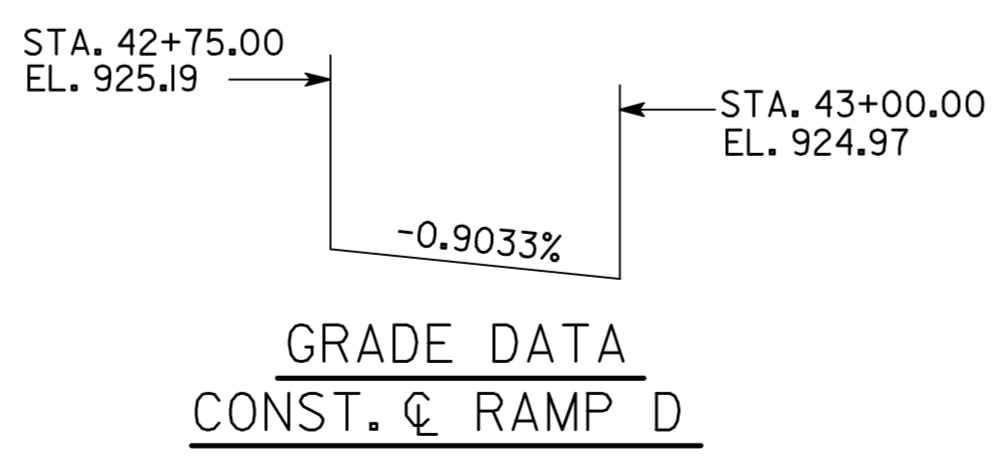
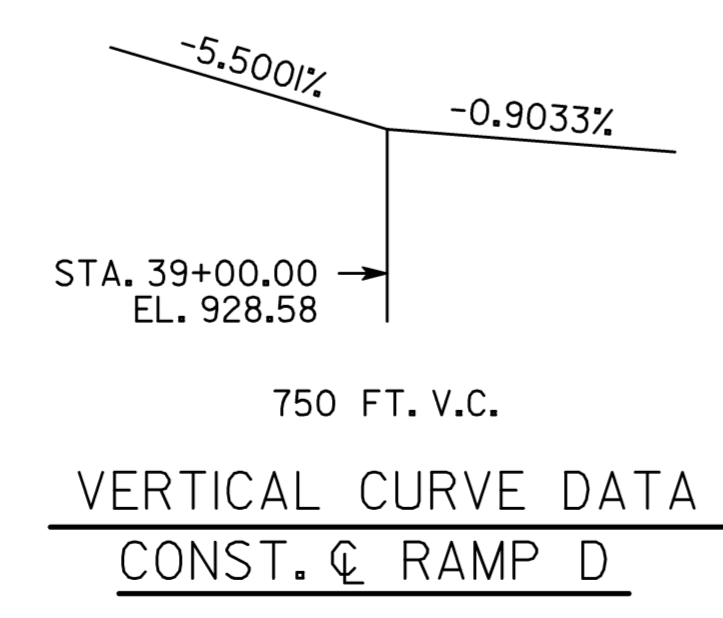

WALL NO. 3		GEORGIA	
DEPARTMENT OF TRANSPORTATION			
ENGINEERING DIVISION-OFFICE OF BRIDGES AND STRUCTURES			
PLAN AND ELEVATION - RETAINING WALL 3			
S.R. 81 OVER S.R. 316			
BARROW COUNTY		CSNHS-0008-00(492)	
SCALE: 1" = 10'-0" (UNLESS NOTED)		OCTOBER 2014	
DESIGNED	TKH	CHECKED	DPD
DRAWN	WMC	DESIGN GROUP	DPD
REVIEWED	DLC/WMD	APPROVED	BFR

1 INCH WHEN PRINTED FULL SIZE

FILENAME: B0008429WALLS123.DGN

12/18/2014 8:17:51 AM \\projects\0008429 - Barrow\DGN-V7\JNB\0008429walls123.dgn