

# DEPARTMENT OF TRANSPORTATION STATE OF GEORGIA

## EROSION, SEDIMENT & POLLUTION CONTROL PLAN SR 26 AT OCMULGEE RIVER FEDERAL AID PROJECT CSBRG-0007-00(050)

GEORGIA D.O.T. P.I. NO. 0007050  
FEDERAL ROUTE NO. 341, 129  
STATE ROUTE NO. 26, 257, 230, 112, 27

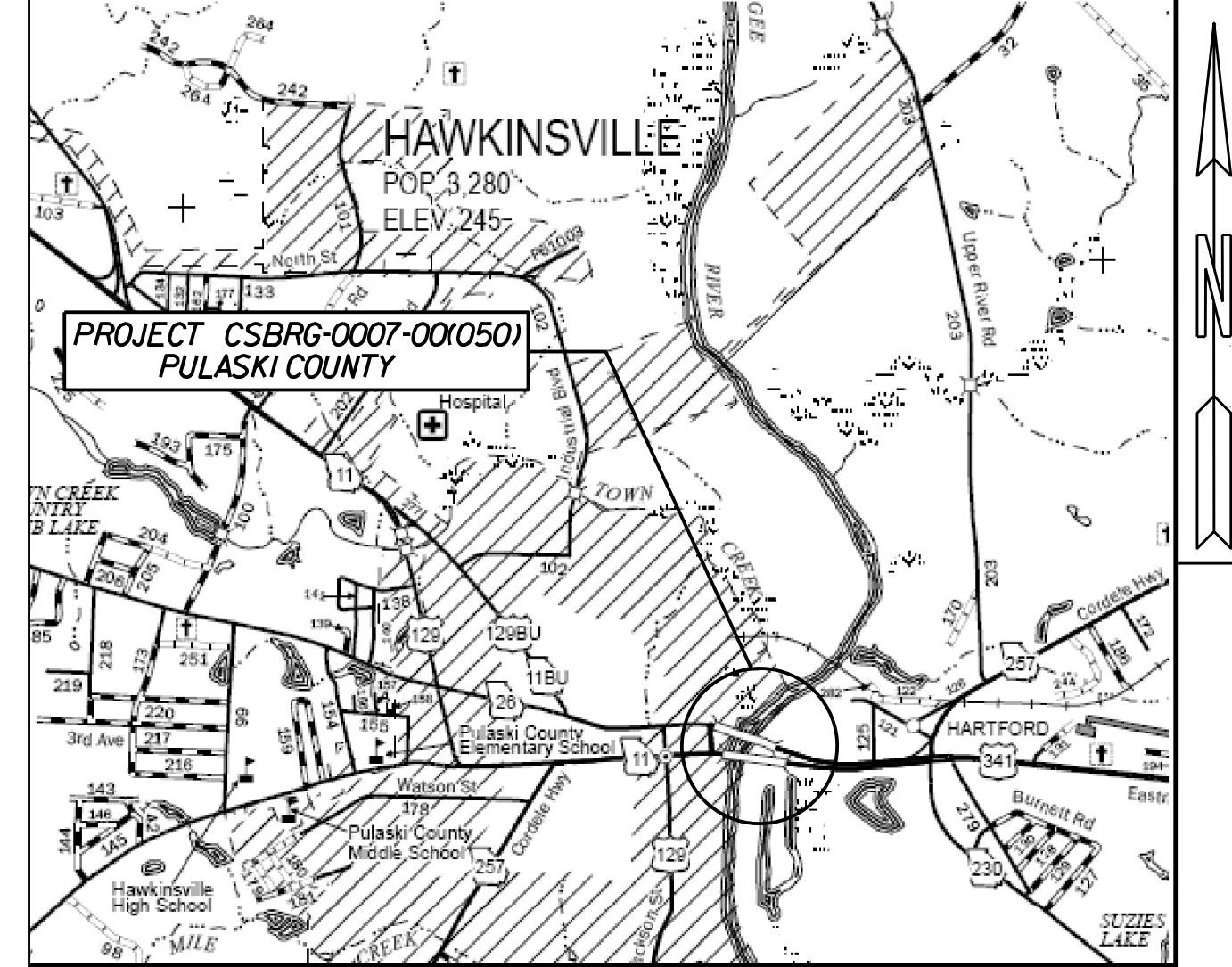
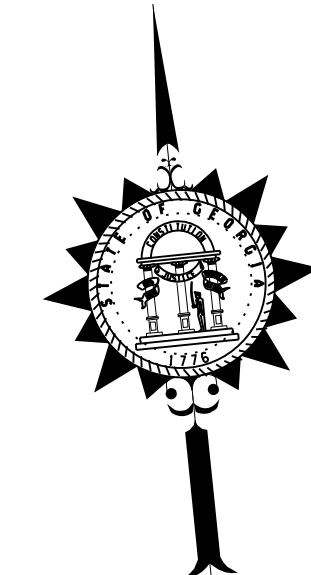

LOCATION SKETCH

THIS PROJECT HAS BEEN PREPARED USING THE HORIZONTAL GEORGIA COORDINATE SYSTEM OF 1984 (NAD1983)94 WEST ZONE, AND THE NORTHAMERICAN VERTICAL DATUM (NAVD) OF 1988.

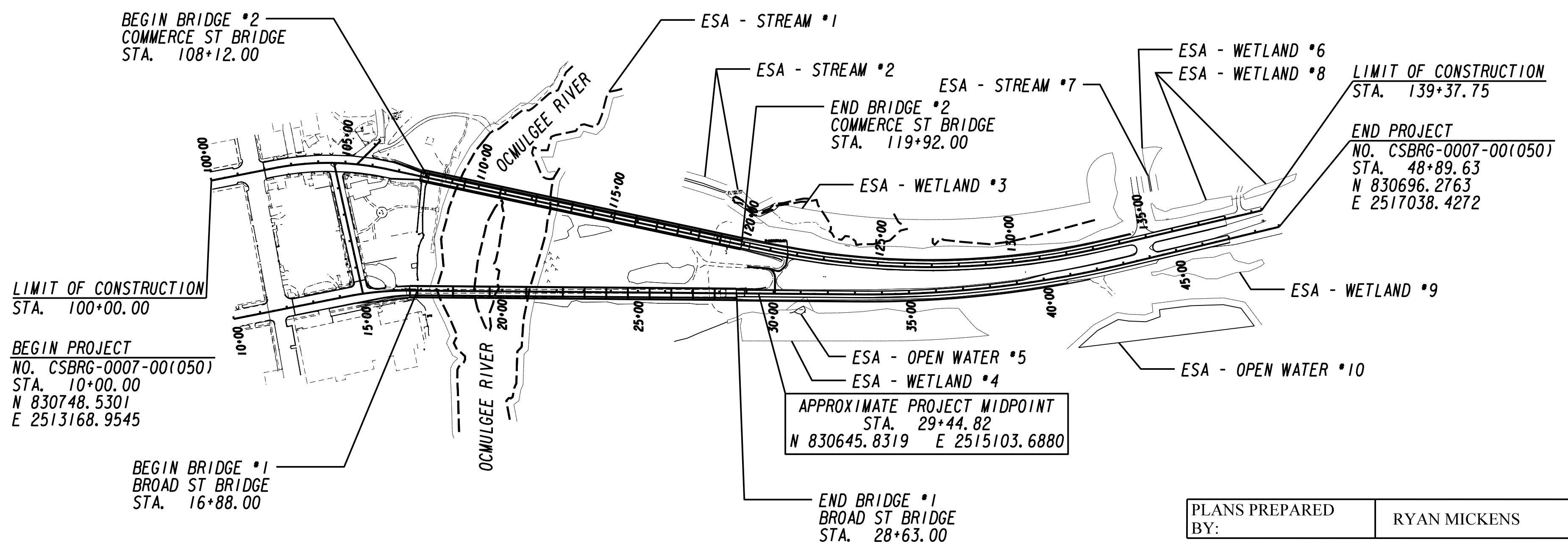

**PRIMARY PERMITEE**  
NAME: GEORGIA DEPARTMENT OF TRANSPORTATION  
ADDRESS: ONE GEORGIA CENTER  
600 WEST PEACHTREE STREET, N.W.  
ATLANTA, GA 30308  
PHONE: (404) 631-1990

**24 HOUR CONTACT:**  
Name \_\_\_\_\_  
Phone Number \_\_\_\_\_  
Contractor shall complete the information in this box.

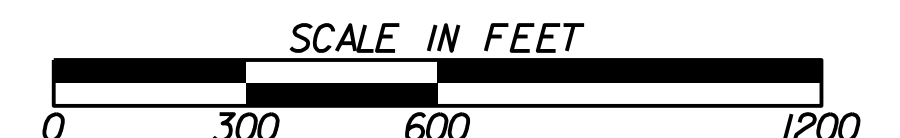

LENGTH OF PROJECT	COUNTY No.: 235 PROJECT No.: 0007050		
	EB	WB	TOTAL
	MILES	MILES	MILES
NET LENGTH OF ROADWAY	0.514	0.522	1.036
NET LENGTH OF BRIDGES	0.223	0.223	0.446
NET LENGTH OF PROJECT	0.737	0.746	1.482
NET LENGTH OF EXCEPTIONS	0.000	0.000	0.000
GROSS LENGTH OF PROJECT	0.737	0.746	1.482

PLANS PREPARED BY:	RYAN MICKENS DESIGN ENGINEER II	
PLANS PREPARED BY:	JOSHUA B. TAYLOR, P.E. DESIGN ENGINEER GROUP MANAGER	
RECOMMENDED FOR APPROVAL BY:	C. ANDY CASEY, P.E. STATE ROADWAY DESIGN ENGINEER	
DATE	RUSSELL MCMURRY, P.E. - CHIEF ENGINEER	0000012103 GSWCC Level II Certification Number

PLANS COMPLETED --		LOCATION & DESIGN APPROVAL --		
REVISIONS				
DATE	ENTITY REQUESTING REVISION(S)	SHEET(S)	SIGNATURE	GSWCC Level II Certification Number