

STAGE 2

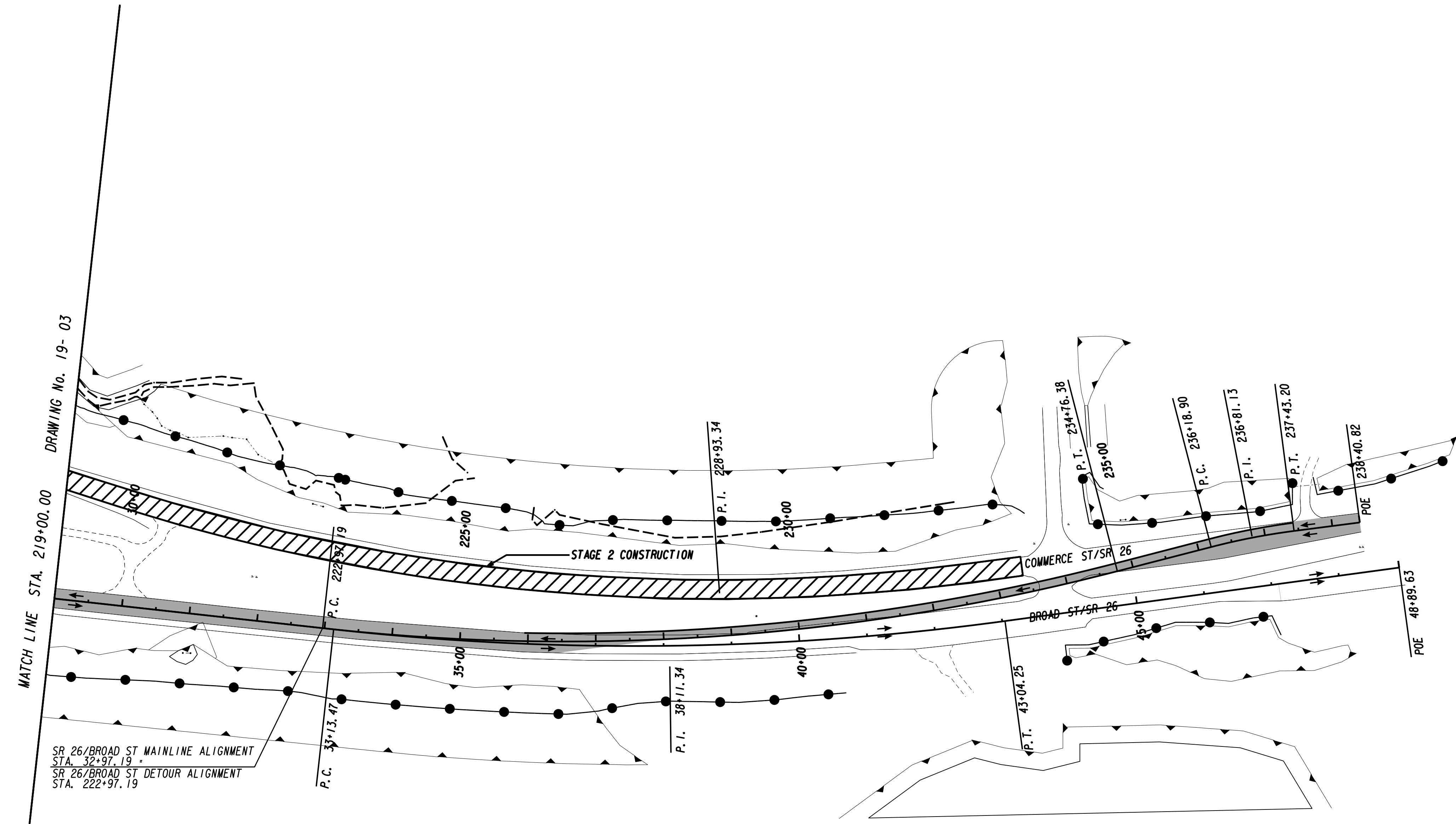

SEQUENCE OF OPERATIONS

- (A) DETOUR TRAFFIC ONTO BRIDGE # 1 - BROAD ST TO PROVIDE ONE LANE IN EACH DIRECTION AS SHOWN.
- (B) DEMOLISH AND RECONSTRUCT BRIDGE # 2 AS PER THE PLANS.

NOTE: THE SPEED DESIGN THROUGH THE CONSTRUCTION ZONE IS 35 MPH. INBOUND TRUCK TRAFFIC IS TO PROCEED ALONG SR 26/BROAD ST AS SHOWN.

LEGEND

	CONSTRUCTION
	LANES OPEN TO TRAFFIC
	TRUCK DETOUR ROUTE

GEORGIA
DEPARTMENT
OF
TRANSPORTATION

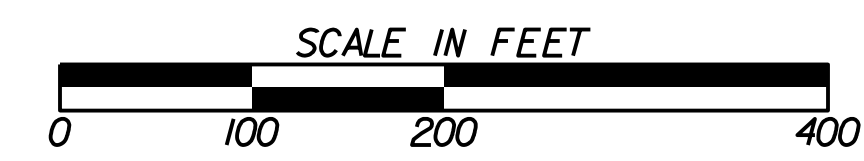

REVISION DATES	

STATE OF GEORGIA
DEPARTMENT OF TRANSPORTATION
OFFICE: ROADWAY DESIGN
CONSTRUCTION STAGING PLAN
SR @ 26 OCMULGEE RIVER
STAGE 2

DRAWING No.
19-011