

LOCATION SKETCH

DEPARTMENT OF TRANSPORTATION STATE OF GEORGIA

PLAN AND PROFILE OF PROPOSED SR 26 AT OCMULGEE RIVER

FEDERAL AID PROJECT
CSBRG-0007-00(050)
PULASKI COUNTY

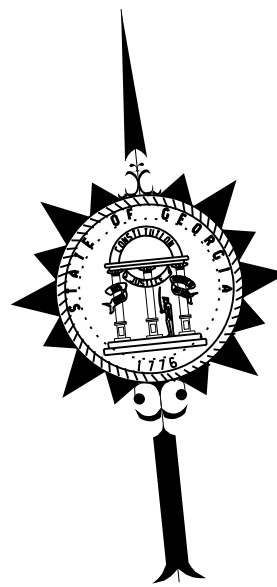

FEDERAL ROUTE NO.: 341,129
STATE ROUTE NO.: 26,257,230,112,27
P.I. NO.: 0007050

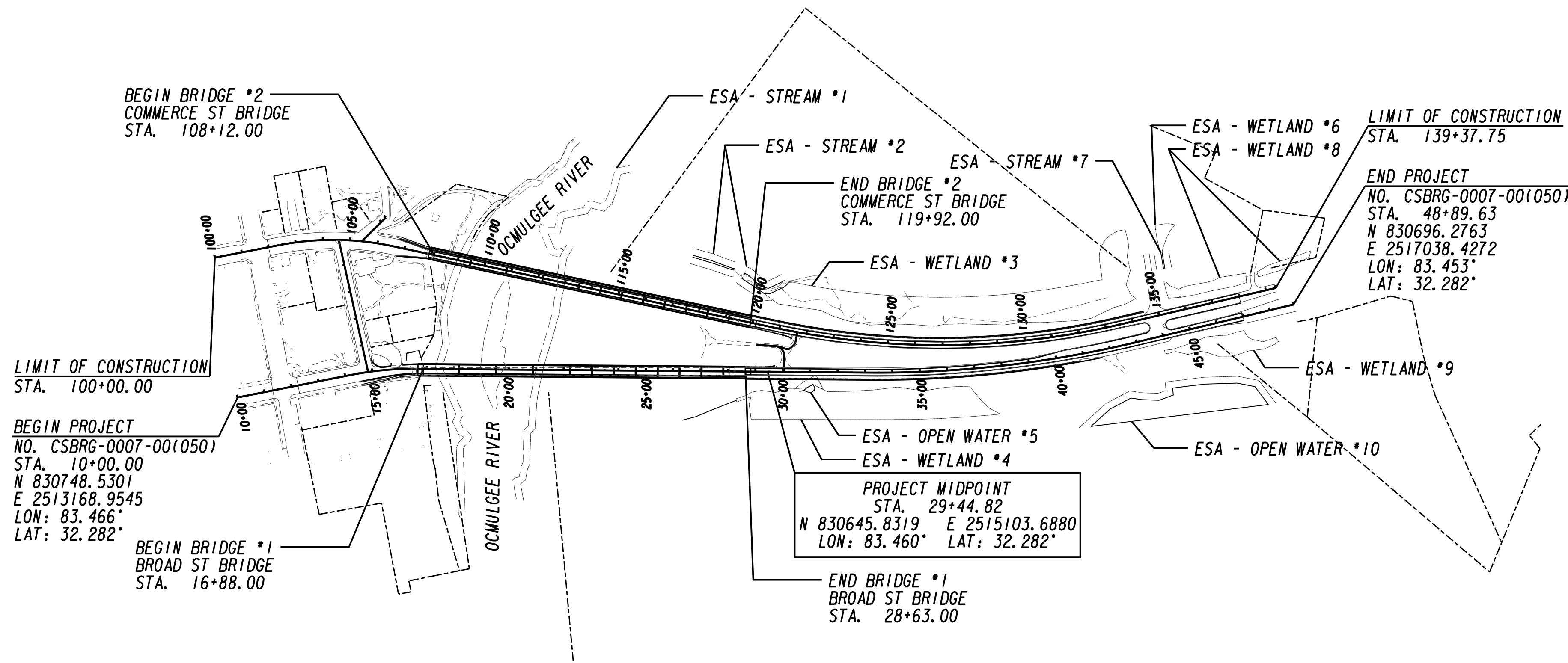

PREPARED BY: RYAN MICKENS
DESIGN ENGINEER 2

RECOMMENDED FOR SUBMISSION BY: JOSHUA TAYLOR, P.E.
DESIGN ENGINEER GROUP MANAGER

SUBMITTED BY: _____
STATE DESIGN ENGINEER

DATE	CHIEF ENGINEER
PLANS COMPLETED	- -
REVISIONS	

THIS PROJECT HAS BEEN PREPARED USING THE HORIZONTAL GEORGIA COORDINATE SYSTEM OF 1984 (NAD 1983/94 WEST ZONE, AND THE NORTH AMERICAN VERTICAL DATUM (NAVD) OF 1988.

NOTE : ALL REFERENCES IN THIS DOCUMENT, WHICH INCLUDES ALL PAPERS, WRITINGS, DOCUMENTS, DRAWINGS, OR PHOTOGRAPHS USED, OR TO BE USED IN CONNECTION WITH THIS DOCUMENT, TO "STATE HIGHWAY DEPARTMENT OF GEORGIA", "STATE HIGHWAY DEPARTMENT", "GEORGIA STATE HIGHWAY DEPARTMENT", "HIGHWAY DEPARTMENT", OR "DEPARTMENT" WHEN THE CONTEXT THEREOF MEANS THE STATE HIGHWAY DEPARTMENT OF GEORGIA, AND SHALL BE DEEMED TO MEAN THE DEPARTMENT OF TRANSPORTATION.

THE DATA TOGETHER WITH ALL OTHER INFORMATION SHOWN ON THESE PLANS OR IN ANYWAY INDICATED THEREBY, WHETHER BY DRAWINGS OR NOTES, OR IN ANY OTHER MANNER, ARE BASED UPON FIELD INVESTIGATIONS AND ARE BELIEVED TO BE INDICATIVE OF ACTUAL CONDITIONS. HOWEVER, THE SAME ARE SHOWN AS INFORMATION ONLY, ARE NOT GUARANTEED, AND DO NOT BIND THE DEPARTMENT OF TRANSPORTATION IN ANY WAY. THE ATTENTION OF BIDDER IS SPECIFICALLY DIRECTED TO SUBSECTIONS 102.04, 102.05, AND 104.03 OF THE SPECIFICATIONS.

LENGTH OF PROJECT	COUNTY: PULASKI COUNTY NUMBER: 235 PROJECT NUMBER: 0007050		
	EB MILES	WB MILES	TOTAL
NET LENGTH OF ROADWAY	0.514	0.522	1.036
NET LENGTH OF BRIDGES	0.223	0.223	0.446
NET LENGTH OF PROJECT	0.737	0.746	1.482
NET LENGTH OF EXCEPTIONS	0.000	0.000	0.000
GROSS LENGTH OF PROJECT	0.737	0.746	1.482

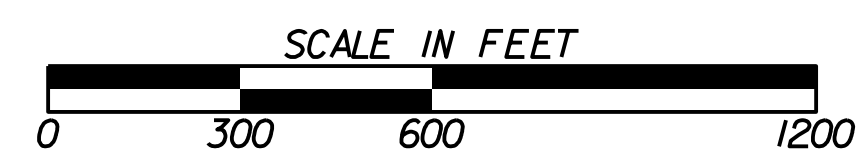

DRAWING No. 01-001