

STATE	PROJECT NUMBER	SHEET NO.	TOTAL SHEETS
GA.			

PI STA = 1341+60.59
 PC STA = 1315+82.79
 PT STA = 1362+79.25
 D = 1°-15'-00.0"
 Δ = 58°-42'-20.6" (LT)
 T = 2577.80
 L = 4696.46
 R = 4583.66
 E = 675.14
 SE = 4.00 %

PVI STA. 1320+00.00
 EL. 159.37

PVI STA. 1354+00.00
 EL. 176.37

+0.5000%

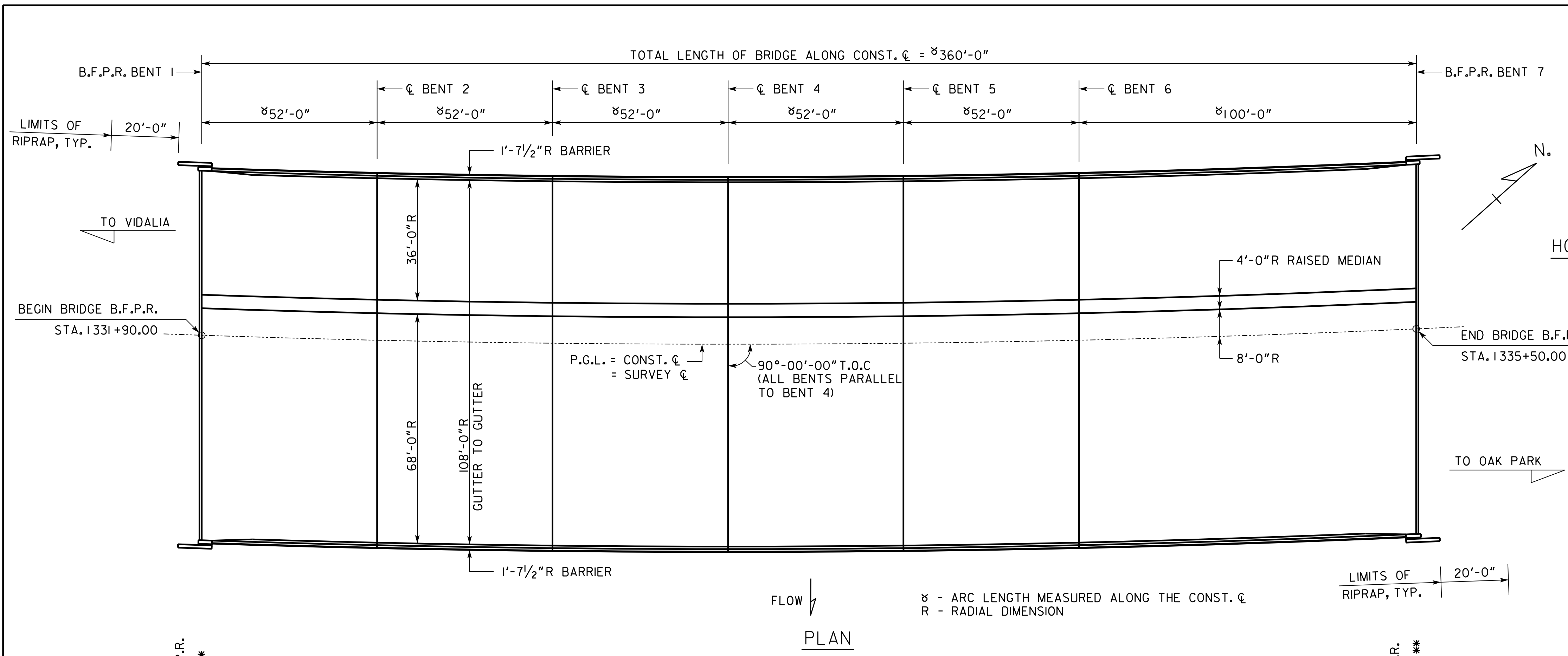

HORIZONTAL CURVE DATA
 PROPOSED GRADE DATA

PROPOSED BRIDGE CONSISTS OF
 5 - 52'-0" TYPE II PSC BEAM SPANS ----- SPECIAL DESIGN
 1 - 100'-0" BULB TEE, 54 IN, PSC BEAM SPAN ----- SPECIAL DESIGN
 2 - PILE END BENTS ----- SPECIAL DESIGN
 4 - PILE INTERMEDIATE BENTS ----- SPECIAL DESIGN
 1 - CONCRETE INTERMEDIATE BENT ----- SPECIAL DESIGN
 24" TYPE I RIP RAP

DESIGN DATA
 SPECIFICATIONS ----- AASTHO LRFD, 6TH EDITION, 2012
 DESIGN VEHICLE LIVE LOAD ----- HL-93
 FUTURE PAVING ALLOWANCE ----- 30 LBS PER SQ FT

TRAFFIC DATA
 TRAFFIC ----- ADT = 5550 (2019)
 ----- ADT = 6750 (2039)
 DESIGN SPEED ----- 65 MPH
 TRUCKS ----- 24 %
 24 HR TRUCKS ----- 31 %
 DIRECTIONAL ----- 50/50

EXISTING UTILITIES
 NO UTILITIES WITHIN THE VICINITY OF THE NEW PROPOSED BRIDGE SITE.

NOTES
 CROSS-SLOPE - THE PROPOSED BRIDGE DECK IS TO BE BUILT ON A CONSTANT CROSS SLOPE OF 4.0% SLOPING DOWN TO THE LEFT.
 DECK DRAINS - DECK DRAINS TO BE PLACED AT 10 FT SPACING ALONG THE NORTHBOUND FACE OF THE MEDIAN. ELIMINATE DECK DRAINS OVER ENDFILLS.
 BENT LAYOUT - BENT 4 IS TO BE BUILT NORMAL TO THE CONST. CL. ALL BENTS ARE PARALLEL TO BENT 4.
 BEAM ELEVATION - MINIMUM BOTTOM OF BEAM ELEVATION FOR PROPOSED BRIDGE SHALL BE NO LOWER THAN ELEVATION 158.20.
 SR 4 (US 1) TRAFFIC WILL BE MAINTAINED UNTIL THE COMPLETION OF THE NEW PROPOSED ALIGNMENT.

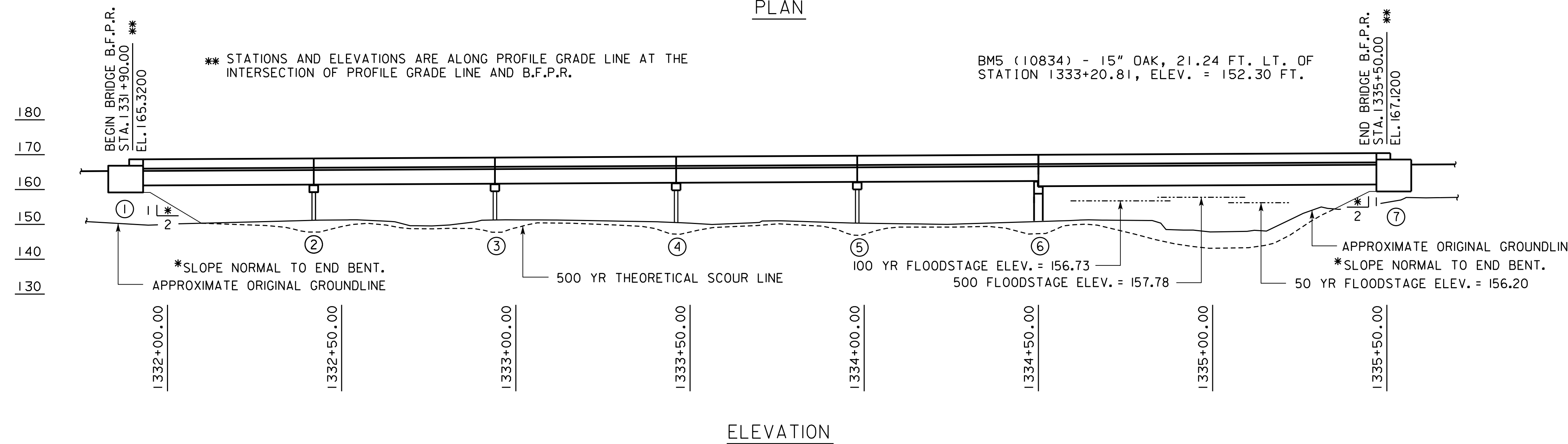

DRAINAGE DATA

DRAINAGE AREA ----- 46.3 SQ MILES

FLOOD FREQUENCY	TOTAL DISCHARGE	MEAN VELOCITY	AREA OF OPENING UNDER FLOODSTAGE	BACKWATER
50 YEAR	3090 CFS	1.87 FPS	1648 SQ FT	0.76 FT
100 YEAR	3710 CFS	2.04 FPS	1815 SQ FT	0.89 FT
500 YEAR	5140 CFS	2.39 FPS	2147 SQ FT	1.17 FT

THEORETICAL SCOUR DEPTHS (FT)

BENT LOCATION	100 YEAR STORM			500 YEAR STORM		
	GENERAL	LOCAL	TOTAL	GENERAL	LOCAL	TOTAL
2-4	0.0	2.7	2.7	0.0	2.9	2.9
5	0.0	2.7	2.7	0.0	3.0	3.0
6	0.0	3.1	3.1	0.0	3.4	3.4

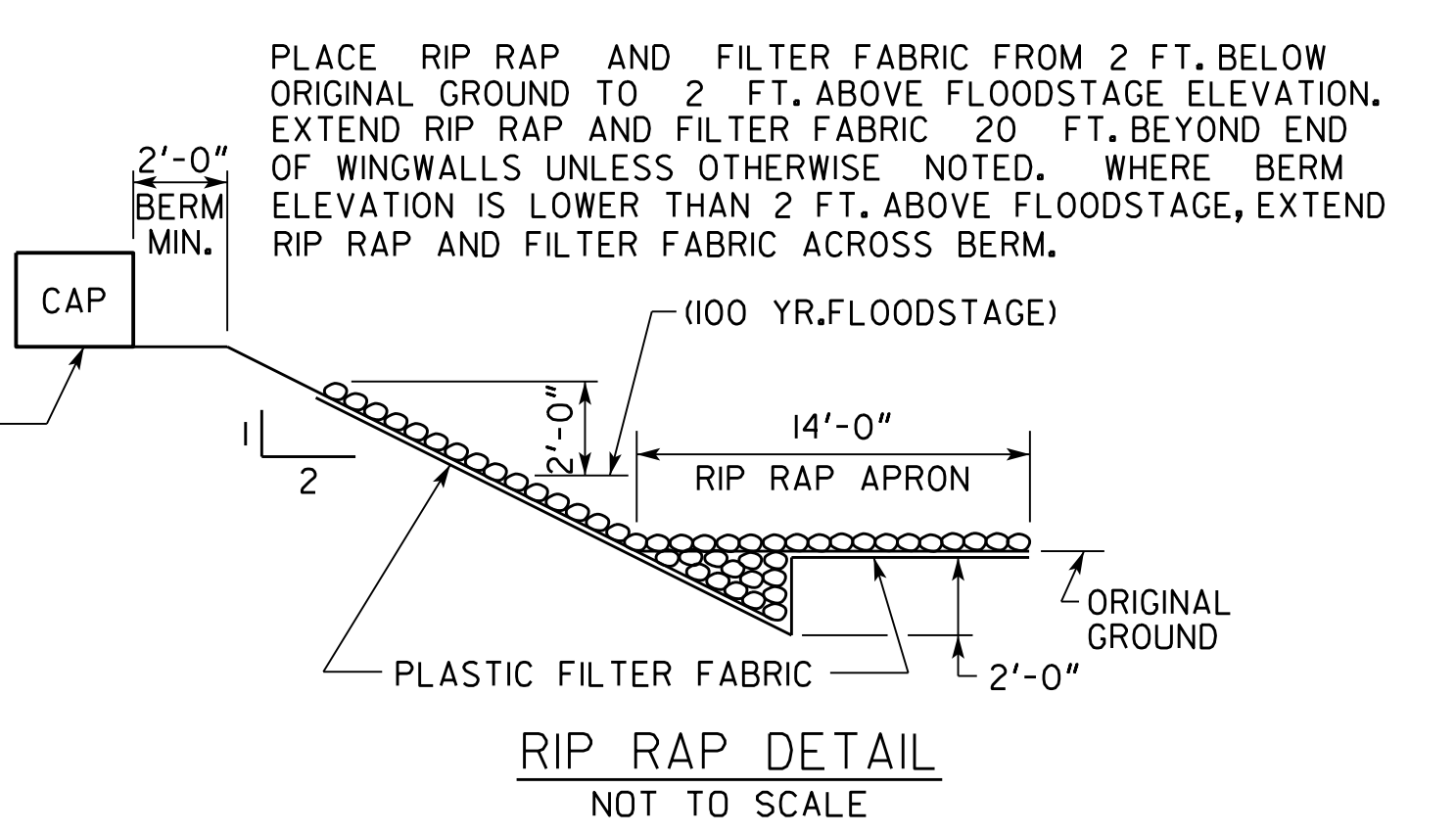

BERM ELEVATIONS (BRIDGE 3)

END BENT	ELEVATIONS
1 LT	157.23
1 RT	161.55
7 LT	157.53
7 RT	161.85

NOTE: FOR BRIDGE ENDROLL STAKING PURPOSES ONLY.

NOTE: THE 500 YEAR SCOUR DEPTH IN THE RIVER IS 4.7 FT.

BRIDGE SERIAL NO. N/A
 BRIDGE I.D. NO. N/A
 PROJECT P.I. NO. 522200-

BRIDGE NO. 3
GEORGIA

DEPARTMENT OF TRANSPORTATION
ENGINEERING DIVISION-OFFICE OF BRIDGES & STRUCTURES

PRELIMINARY LAYOUT
SR 4 (US 1) OVER SWIFT CREEK
TOOMBS COUNTY EDS00-0045-00(026)

SCALE: 1" = 20'-0" (UNLESS OTHERWISE NOTED) AUGUST 2014

DESIGNED: TDN	CHECKED: STB	REVIEWED: DLC/WMD
DRAWN: TON	DESIGN GROUP: STB	APPROVED: BFR

1/4" = 1" WHEN PRINTED FULL SIZE

9/20/2014 2:46:03 PM
 10/22/2014 10:58:00 AM